

Thyristor \ Diode Module

 $V_{RRM} = 2 \times 1800 \text{ V}$
 $I_{TAV} = 250 \text{ A}$
 $V_T = 1.08 \text{ V}$

Phase leg

Part number

MCD255-18io1

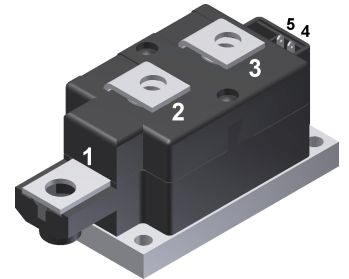

Backside: isolated

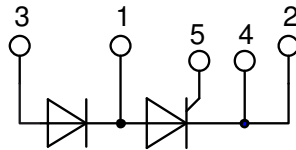

Features / Advantages:

- International standard package
- Direct copper bonded Al₂O₃-ceramic with copper base plate
- Planar passivated chip
- Isolation voltage 3600 V~
- Keyed gate/cathode twin pins

Applications:

- Motor control, softstarter
- Power converter
- Heat and temperature control for industrial furnaces and chemical processes
- Lighting control
- Solid state switches

Package: Y1

- Isolation Voltage: 3600 V~
- Industry standard outline
- RoHS compliant
- Soldering pins for PCB mounting
- Base plate: Copper internally DCB isolated
- Advanced power cycling

Terms Conditions of usage:

The data contained in this product data sheet is exclusively intended for technically trained staff. The user will have to evaluate the suitability of the product for the intended application and the completeness of the product data with respect to his application. The specifications of our components may not be considered as an assurance of component characteristics. The information in the valid application- and assembly notes must be considered. Should you require product information in excess of the data given in this product data sheet or which concerns the specific application of your product, please contact your local sales office.

Due to technical requirements our product may contain dangerous substances. For information on the types in question please contact your local sales office.

Should you intend to use the product in aviation, in health or life endangering or life support applications, please notify. For any such application we urgently recommend

- to perform joint risk and quality assessments;

- the conclusion of quality agreements;

- to establish joint measures of an ongoing product survey, and that we may make delivery dependent on the realization of any such measures.

| Rectifier | | | Ratings | | | |
|----------------|--|---|-------------------------|------|-------|-------------------|
| Symbol | Definition | Conditions | min. | typ. | max. | Unit |
| $V_{RSM/DSM}$ | max. non-repetitive reverse/forward blocking voltage | $T_{VJ} = 25^{\circ}C$ | | | 1900 | V |
| $V_{RRM/DRM}$ | max. repetitive reverse/forward blocking voltage | $T_{VJ} = 25^{\circ}C$ | | | 1800 | V |
| I_{RD} | reverse current, drain current | $V_{R/D} = 1800\text{ V}$ | $T_{VJ} = 25^{\circ}C$ | | 1 | mA |
| | | $V_{R/D} = 1800\text{ V}$ | $T_{VJ} = 140^{\circ}C$ | | 40 | mA |
| V_T | forward voltage drop | $I_T = 300\text{ A}$ | $T_{VJ} = 25^{\circ}C$ | | 1.14 | V |
| | | $I_T = 600\text{ A}$ | | | 1.36 | V |
| | | $I_T = 300\text{ A}$ | $T_{VJ} = 125^{\circ}C$ | | 1.08 | V |
| | | $I_T = 600\text{ A}$ | | | 1.33 | V |
| I_{TAV} | average forward current | $T_C = 85^{\circ}C$ | $T_{VJ} = 140^{\circ}C$ | | 250 | A |
| $I_{T(RMS)}$ | RMS forward current | 180° sine | | | 450 | A |
| V_{T0} | threshold voltage | } for power loss calculation only | $T_{VJ} = 140^{\circ}C$ | | 0.80 | V |
| r_T | slope resistance | | | | 0.68 | mΩ |
| R_{thJC} | thermal resistance junction to case | | | | 0.14 | K/W |
| R_{thCH} | thermal resistance case to heatsink | | 0.040 | | | K/W |
| P_{tot} | total power dissipation | | $T_C = 25^{\circ}C$ | | 820 | W |
| I_{TSM} | max. forward surge current | $t = 10\text{ ms}; (50\text{ Hz}), \text{ sine}$ | $T_{VJ} = 45^{\circ}C$ | | 9.20 | kA |
| | | $t = 8,3\text{ ms}; (60\text{ Hz}), \text{ sine}$ | $V_R = 0\text{ V}$ | | 9.94 | kA |
| | | $t = 10\text{ ms}; (50\text{ Hz}), \text{ sine}$ | $T_{VJ} = 140^{\circ}C$ | | 7.82 | kA |
| | | $t = 8,3\text{ ms}; (60\text{ Hz}), \text{ sine}$ | $V_R = 0\text{ V}$ | | 8.45 | kA |
| I^2t | value for fusing | $t = 10\text{ ms}; (50\text{ Hz}), \text{ sine}$ | $T_{VJ} = 45^{\circ}C$ | | 423.2 | kA ² s |
| | | $t = 8,3\text{ ms}; (60\text{ Hz}), \text{ sine}$ | $V_R = 0\text{ V}$ | | 410.6 | kA ² s |
| | | $t = 10\text{ ms}; (50\text{ Hz}), \text{ sine}$ | $T_{VJ} = 140^{\circ}C$ | | 305.8 | kA ² s |
| | | $t = 8,3\text{ ms}; (60\text{ Hz}), \text{ sine}$ | $V_R = 0\text{ V}$ | | 296.7 | kA ² s |
| C_J | junction capacitance | $V_R = 400\text{ V } f = 1\text{ MHz}$ | $T_{VJ} = 25^{\circ}C$ | 438 | | pF |
| P_{GM} | max. gate power dissipation | $t_p = 30\text{ }\mu\text{s}$ | $T_C = 140^{\circ}C$ | | 120 | W |
| | | $t_p = 500\text{ }\mu\text{s}$ | | | 60 | W |
| P_{GAV} | average gate power dissipation | | | | 20 | W |
| $(di/dt)_{cr}$ | critical rate of rise of current | $T_{VJ} = 140^{\circ}C; f = 50\text{ Hz}$ repetitive, $I_T = 860\text{ A}$ | | | 100 | A/ μs |
| | | $t_p = 200\text{ }\mu\text{s}; di_G/dt = 1\text{ A}/\mu\text{s};$ $I_G = 1\text{ A}; V = \frac{2}{3} V_{DRM}$ non-repet., $I_T = 250\text{ A}$ | | | 500 | A/ μs |
| $(dv/dt)_{cr}$ | critical rate of rise of voltage | $V = \frac{2}{3} V_{DRM}$ $R_{GK} = \infty$; method 1 (linear voltage rise) | $T_{VJ} = 140^{\circ}C$ | | 1000 | V/ μs |
| V_{GT} | gate trigger voltage | $V_D = 6\text{ V}$ | $T_{VJ} = 25^{\circ}C$ | | 2 | V |
| | | | $T_{VJ} = -40^{\circ}C$ | | 3 | V |
| I_{GT} | gate trigger current | $V_D = 6\text{ V}$ | $T_{VJ} = 25^{\circ}C$ | | 150 | mA |
| | | | $T_{VJ} = -40^{\circ}C$ | | 220 | mA |
| V_{GD} | gate non-trigger voltage | $V_D = \frac{2}{3} V_{DRM}$ | $T_{VJ} = 140^{\circ}C$ | | 0.25 | V |
| I_{GD} | gate non-trigger current | | | | 10 | mA |
| I_L | latching current | $t_p = 30\text{ }\mu\text{s}$ | $T_{VJ} = 25^{\circ}C$ | | 200 | mA |
| | | $I_G = 0.45\text{ A}; di_G/dt = 0.45\text{ A}/\mu\text{s}$ | | | | |
| I_H | holding current | $V_D = 6\text{ V } R_{GK} = \infty$ | $T_{VJ} = 25^{\circ}C$ | | 150 | mA |
| t_{gd} | gate controlled delay time | $V_D = \frac{1}{2} V_{DRM}$ | $T_{VJ} = 25^{\circ}C$ | | 2 | μs |
| | | $I_G = 1\text{ A}; di_G/dt = 1\text{ A}/\mu\text{s}$ | | | | |
| t_q | turn-off time | $V_R = 100\text{ V}; I_T = 300\text{ A}; V = \frac{2}{3} V_{DRM}$ $di/dt = 10\text{ A}/\mu\text{s } dv/dt = 50\text{ V}/\mu\text{s } t_p = 200\text{ }\mu\text{s}$ | $T_{VJ} = 125^{\circ}C$ | 200 | | μs |

| Package Y1 | | | | Ratings | | | |
|---------------|--|----------------------|------|---------|------|------|--|
| Symbol | Definition | Conditions | min. | typ. | max. | Unit | |
| I_{RMS} | RMS current | per terminal | | | 600 | A | |
| T_{VJ} | virtual junction temperature | | -40 | | 140 | °C | |
| T_{op} | operation temperature | | -40 | | 125 | °C | |
| T_{stg} | storage temperature | | -40 | | 125 | °C | |
| Weight | | | | | 680 | g | |
| M_D | mounting torque | | 4.5 | | 7 | Nm | |
| M_T | terminal torque | | 11 | | 13 | Nm | |
| $d_{Spp/APP}$ | creepage distance on surface striking distance through air | terminal to terminal | 16.0 | | | mm | |
| $d_{Spb/APb}$ | | terminal to backside | 16.0 | | | mm | |
| V_{ISOL} | isolation voltage | t = 1 second | 3600 | | | V | |
| | | t = 1 minute | 3000 | | | V | |

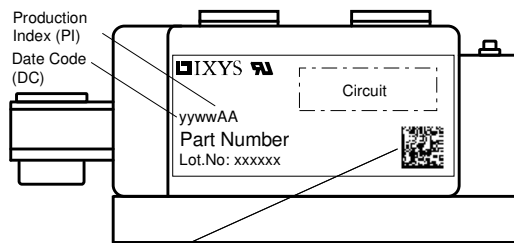

Data Matrix: part no. (1-19), DC + PI (20-25), lot.no.# (26-31), blank (32), serial no.# (33-36)

| Ordering | Ordering Number | Marking on Product | Delivery Mode | Quantity | Code No. |
|----------|-----------------|--------------------|---------------|----------|----------|
| Standard | MCD255-18io1 | MCD255-18io1 | Box | 3 | 461830 |

Equivalent Circuits for Simulation
** on die level*
 $T_{VJ} = 140\text{ °C}$

Thyristor

| | | | |
|--------------|--------------------|-----|----|
| $V_{0\ max}$ | threshold voltage | 0.8 | V |
| $R_{0\ max}$ | slope resistance * | 0.5 | mΩ |

Outlines Y1

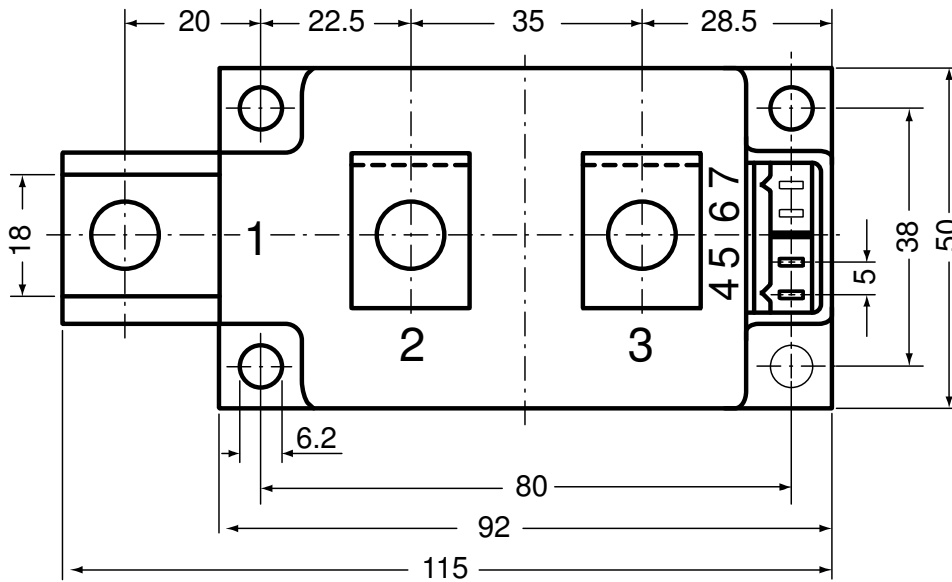
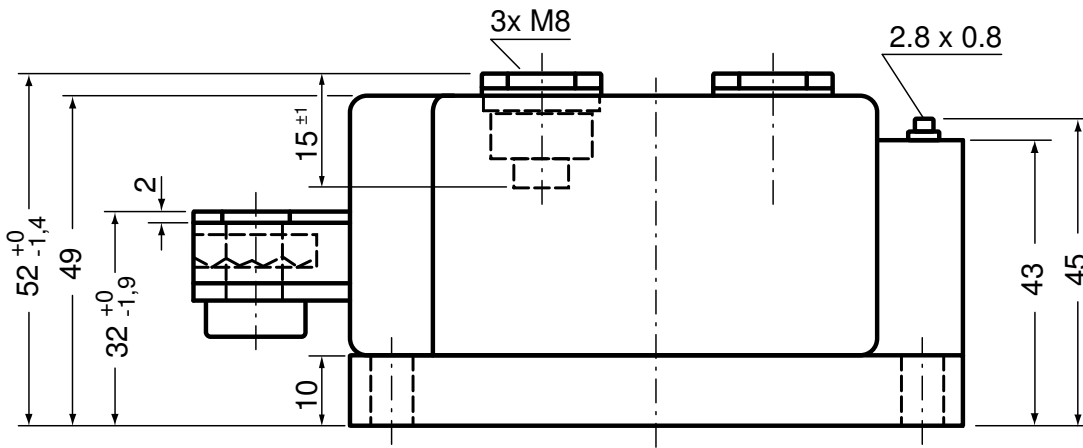

Optional accessories for modules

Keyed gate/cathode twin plugs with wire length = 350 mm, gate = white, cathode = red

Type ZY 180L (L = Left for pin pair 4/5)
 Type ZY 180R (R = Right for pin pair 6/7) } UL 758, style 3751

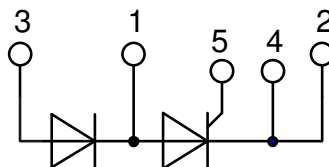

Thyristor

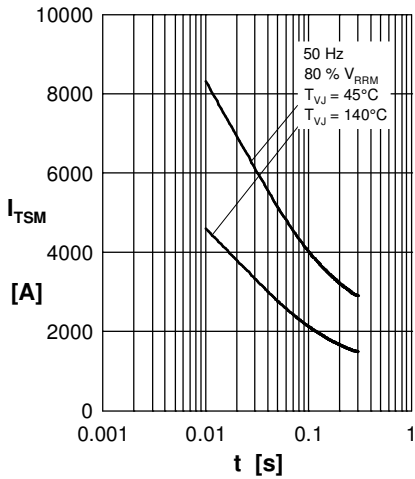

Fig. 1 Surge overload current
 $I_{T(F)SM}$: Crest value, t: duration

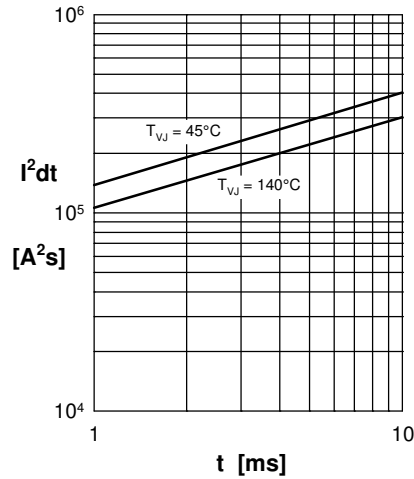

Fig. 2 I^2dt versus time

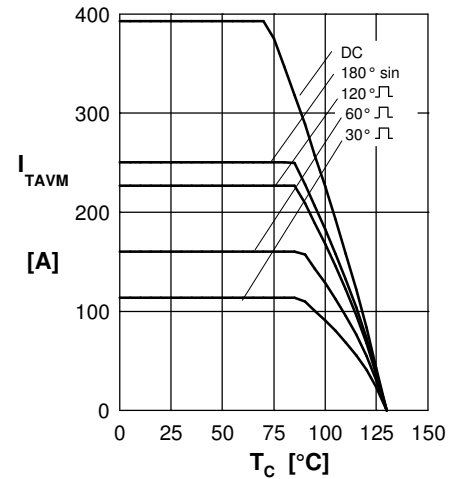

Fig. 3 Max. forward current at case temperature

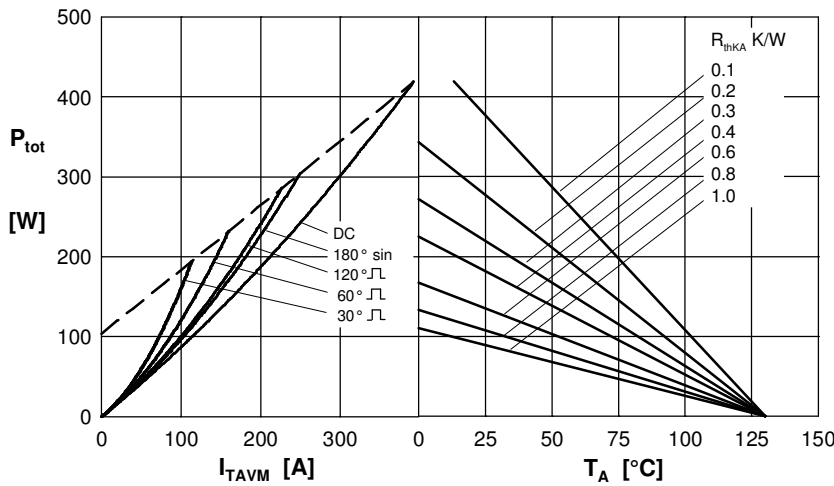

Fig. 4 Power dissipation versus on-state current and ambient temperature (per thyristor or diode)

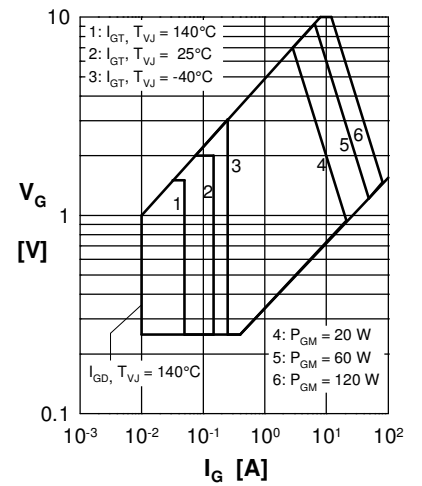

Fig. 5 Surge overload current
 $I_{T(F)SM}$: Crest value, t: duration

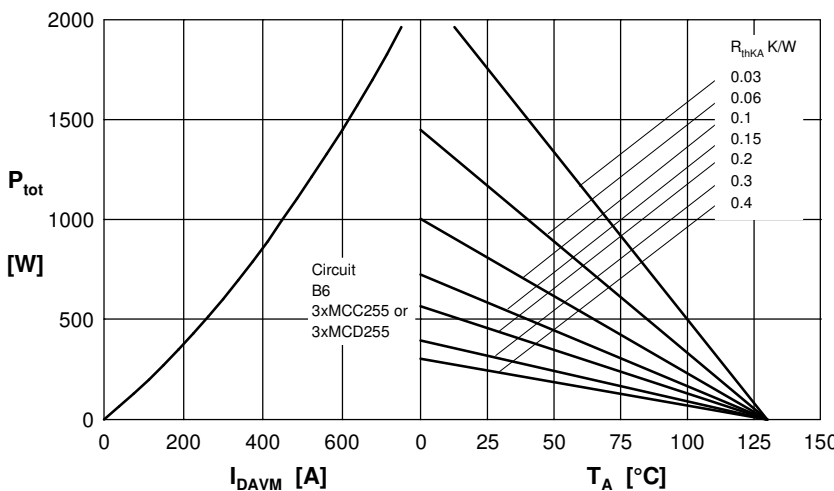

Fig. 6 Three phase rectifier bridge: Power dissipation vs. direct output current and ambient temperature

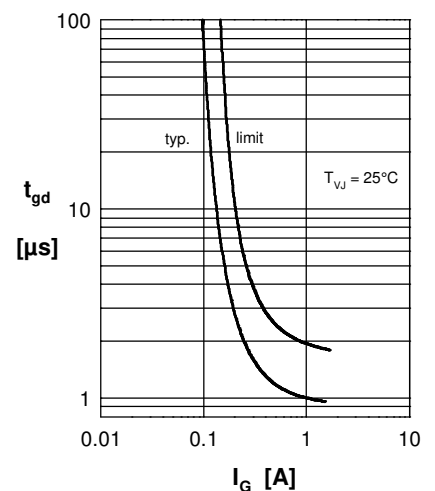

Fig. 7 Gate trigger delay time

Rectifier

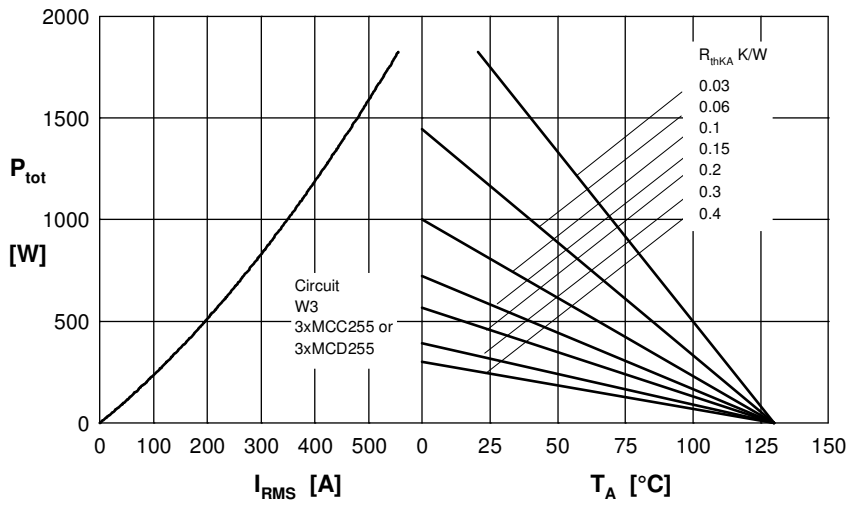
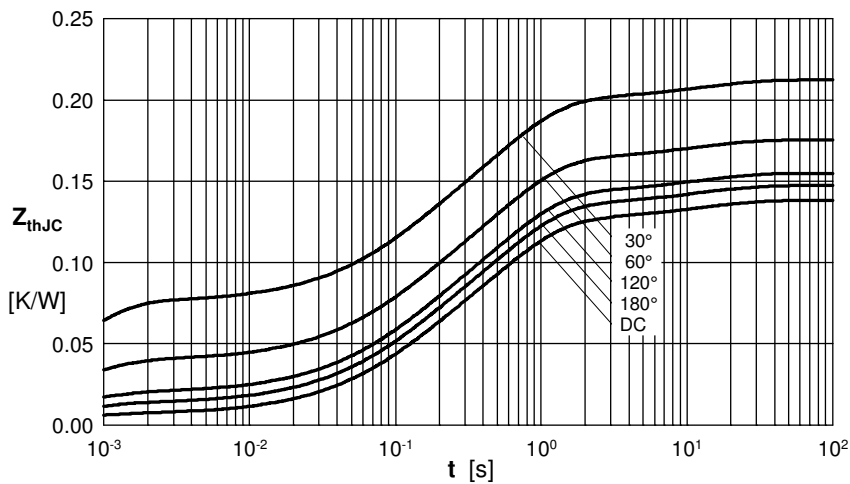

Fig. 8 Three phase AC-controller: Power dissipation versus R_{MS} output current and ambient temperature



R_{thJC} for various conduct. angles d:

| d | R_{thJC} [K/W] |
|------|------------------|
| DC | 0.139 |
| 180° | 0.148 |
| 120° | 0.156 |
| 60° | 0.176 |
| 30° | 0.214 |

Constants for Z_{thJC} calculation:

| i | R_{thi} [K/W] | t_i [s] |
|---|-----------------|-----------|
| 1 | 0.0066 | 0.00054 |
| 2 | 0.0358 | 0.098 |
| 3 | 0.0831 | 0.54 |
| 4 | 0.0129 | 12 |

Fig. 9 Transient thermal impedance junction to case (per thyristor/diode)

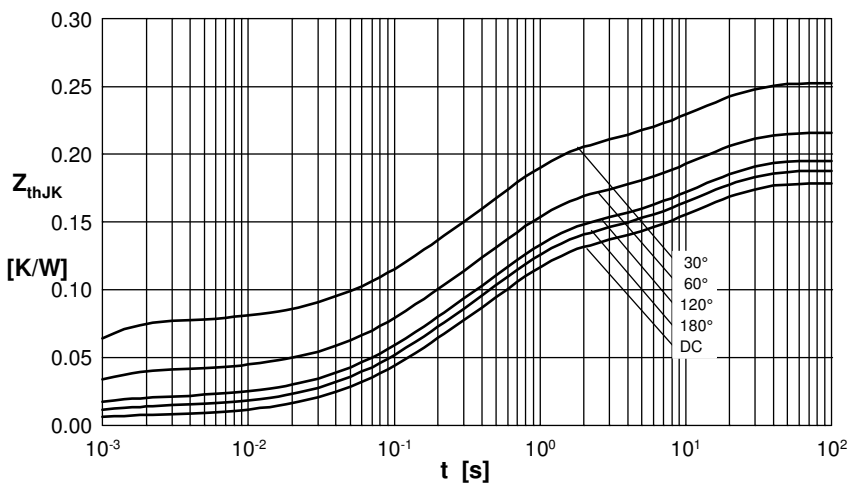

R_{thJK} for various conduct. angles d:

| d | R_{thJK} [K/W] |
|------|------------------|
| DC | 0.179 |
| 180° | 0.188 |
| 120° | 0.196 |
| 60° | 0.216 |
| 30° | 0.254 |

Constants for Z_{thJK} calculation:

| i | R_{thi} [K/W] | t_i [s] |
|---|-----------------|-----------|
| 1 | 0.0066 | 0.00054 |
| 2 | 0.0358 | 0.098 |
| 3 | 0.0831 | 0.54 |
| 4 | 0.0129 | 12 |
| 5 | 0.04 | 12 |

Fig. 10 Transient thermal impedance junction to heatsink (per thyristor/diode)